

School of
**Allied and
Community
Health**

EST 1892 **LSBU**
Institute of Health
& Social Care

Utilising the Education Pillar of practice as a Practice-Based placement experience for Physiotherapy Students

12th October 2023



Background

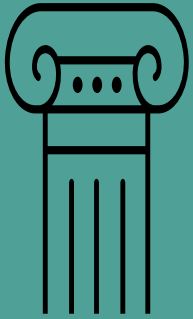

Clinical

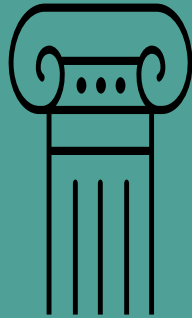

Education

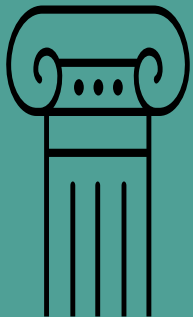

Leadership

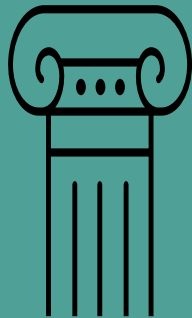

Research

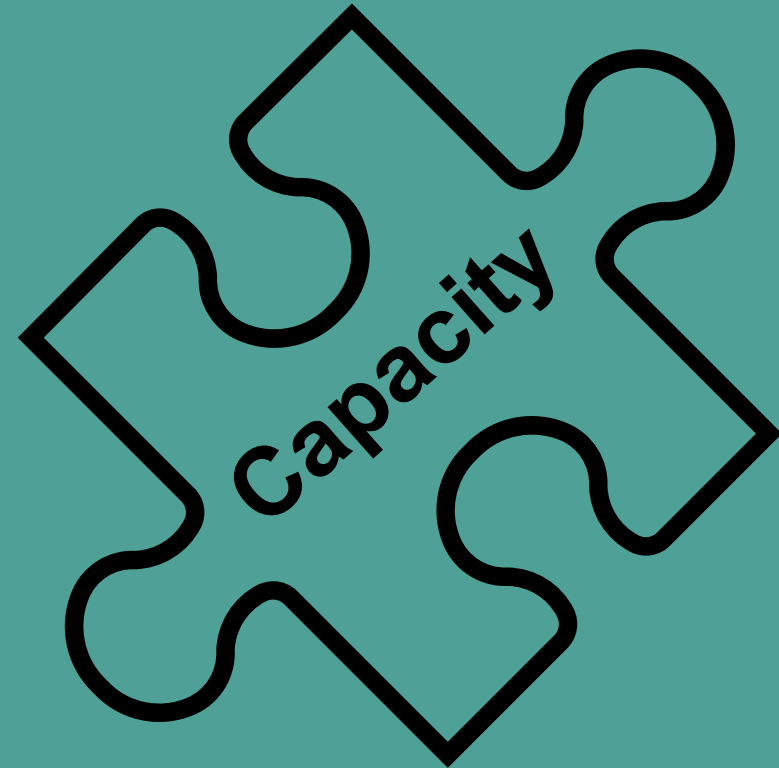

The Plan

- 3 BSc year 2 & 1 MSc year 1 physiotherapy student on a split placement model
- Design simulation training package for upcoming placement rotations

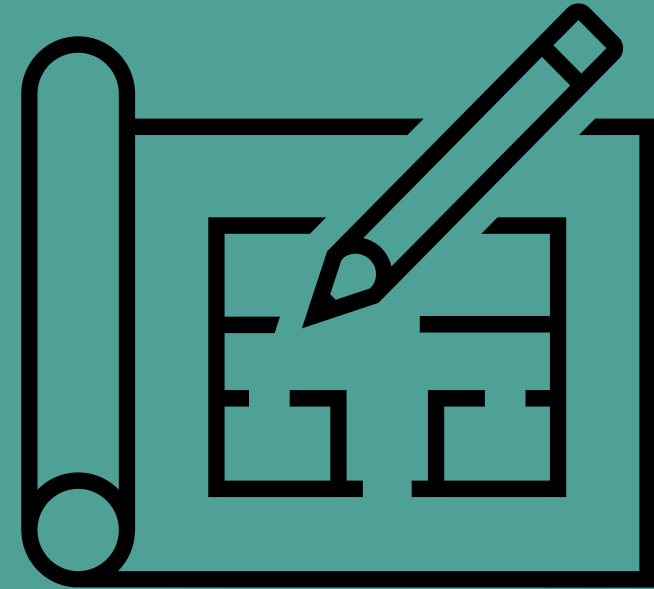

Reality Vs Imagined



School of
**Allied and
Community
Health**

EST 1892
LSBU
Institute of Health
& Social Care

Thank You for Listening

Joanne Harris
Harrij46@lsbu.ac.uk

Allied Health Professions Strategic Practice
Learning & Allied and Community Health
Apprenticeship & Outreach Lead



Please use the QR code to access more
details on content for the placement

